

APPLICABLE STANDARD		MIL-STD-348B			
RATING	OPERATING TEMPERATURE RANGE	-55°C TO +105°C(95%RH MAX)		STORAGE TEMPERATURE RANGE	-55°C TO +50°C(95%RH MAX)
	POWER	_____ W		CHARACTERISTIC IMPEDANCE	50 Ω (0 TO 50 GHz)
	PECULIARITY	_____		APPLICABLE CABLE	FCCAF1:NISSEI ELECTRIC CO.,LTD.
SPECIFICATIONS					
ITEM		TEST METHOD		REQUIREMENTS	
CONSTRUCTION		GENERAL EXAMINATION		VISUALLY AND BY MEASURING INSTRUMENT.	
MARKING		CONFIRMED VISUALLY.		ACCORDING TO DRAWING.	
ELECTRIC CHARACTERISTICS		CONTACT RESISTANCE		100 mA MAX (DC OR 1000 Hz).	
		INSULATION RESISTANCE		500 V DC.	
		VOLTAGE PROOF		500 V AC FOR 1 min.CURRENT LEAKAGE 2mA MAX.	
		VOLTAGE STANDING WAVE RATIO		FREQUENCY 0.045 TO 40 GHz.	
		INSERTION LOSS		FREQUENCY TO GHz.	
MECHANICAL CHARACTERISTICS					
CABLE CLAMP ROBUSTNESS (AGAINST CABLE PULL)		APPLYING A PULL FORCE THE CABLE AXIALLY AT 49 N MAX.		① NO WITHDRAWAL AND BREAKAGE OF CABLE. ② NO BREAKAGE OF CLAMP.	
<p>REMARK ① MEASUREMENT METHOD</p>					
COUNT	DESCRIPTION OF REVISIONS		DESIGNED	CHECKED	DATE
①					
REMARK 2.RoHS COMPLIANT			APPROVED	KY. SHIMIZU	15.01.17
			CHECKED	KY. SHIMIZU	15.01.17
			DESIGNED	TS. SAWAI	15.01.17
			DRAWN	TS. SAWAI	15.01.17
Unless otherwise specified, refer to MIL-STD-202.			DRAWING NO.		ELC-358099-01-01
Note QT:Qualification Test AT:Assurance Test X:Applicable Test					
HRS	SPECIFICATION SHEET		PART NO.	H2. 4-2P-FCCAF1-A-100RS	
	HIROSE ELECTRIC CO., LTD.		CODE NO.	CL321-6174-0-01	① 1/1

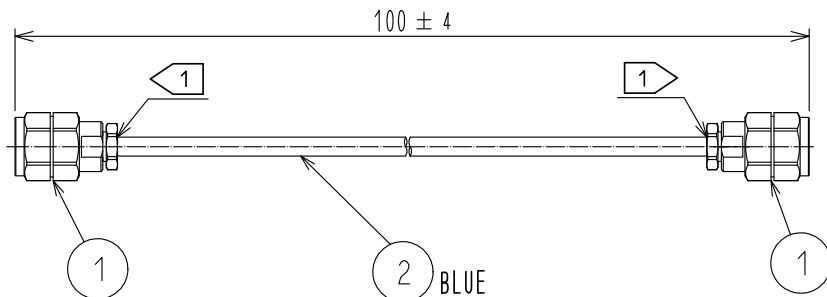

[DIMENSIONS OF CONNECTOR]

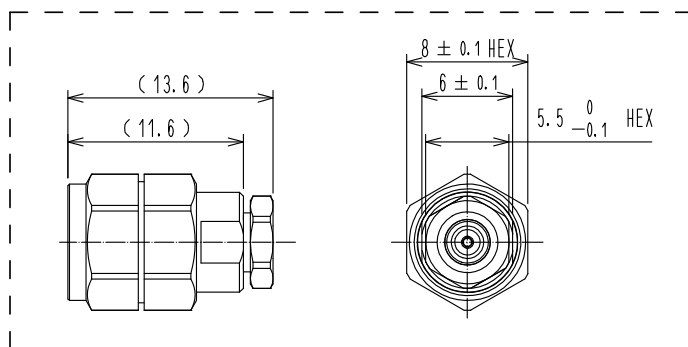

NOTE 1 Do not apply any excessive stress to the cable assembly position.

RoHS COMPLIANT

1	H2. 4-P-FCCAF1	CL338-0600-5-00	2	FCCAF1	NISSEI ELECTRIC CO., LTD.		
NO.	PART No.	CL CODE	NO.	PART No.	MANUFACTURER		
UNITS mm		SCALE FREE	COUNT 	DESCRIPTION OF REVISIONS	DESIGNED	CHECKED	DATE
HRS HIROSE ELECTRIC CO., LTD.	APPROVED	: KY. SHIMIZU		15. 01. 17	DRAWING NO. EDC-358099-01-01		
	CHECKED	: KY. SHIMIZU		15. 01. 17	PART NO. H2. 4-2P-FCCAF1-A-100RS		
	DESIGNED	: TS. SAWAI		15. 01. 17	CODE NO. CL321-6174-0-01		
	DRAWN	: TS. SAWAI		15. 01. 17	1/1		